

WILLIAMS ISLAND

Contemplated Projects:

1) Gatehouse, Entry Monument, Resident's Gatehouse, Bus Benches & Misc. Directional Signage	\$1.5 Million
2) Spa Entry, Porte Cochere & Stairs	\$150K
3) Island Club Pool & Bar	\$1 Million
4) Island Club Ballroom and Restaurant	\$2 Million
5) General Landscape, Lighting, Sidewalks, Vita Course	\$500K
6) Cafe, Deck & Rails, Tented Roofing, and Kitchen	\$500K

Possible future opportunities for discussion:

- A) Island Shop at Trailer Triangle
- B) Young Adult and Children's Amenity





Casual Luxury



Terrace Precedent Imagery



Nomadic Sensibility



The sensation of warm boards underfoot, the innocent anticipation of unveiling the beach beyond the island dunes.
 An enveloping, heartwarming sense of arrival.
 Unfolding, shielding the sun with a white canvas umbrella - the carefree nomad achieving temporary appropriation of personal space. Personal space that is to be cared for, and to be shared with, closest friends and family.

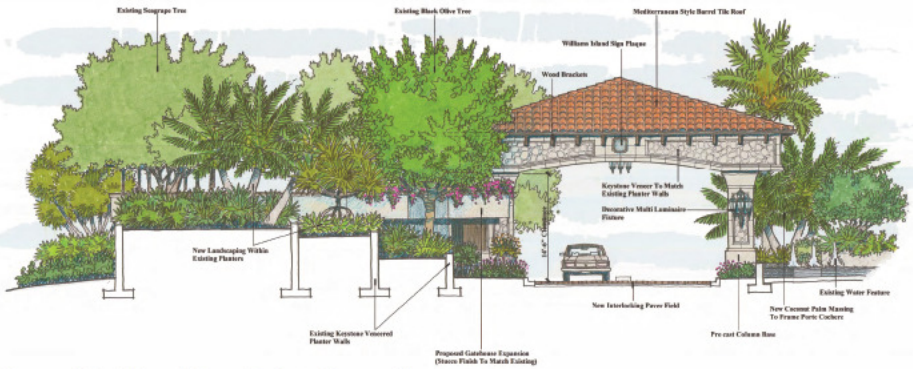

Proposed Gate House & Porte Cochere Character Elevation

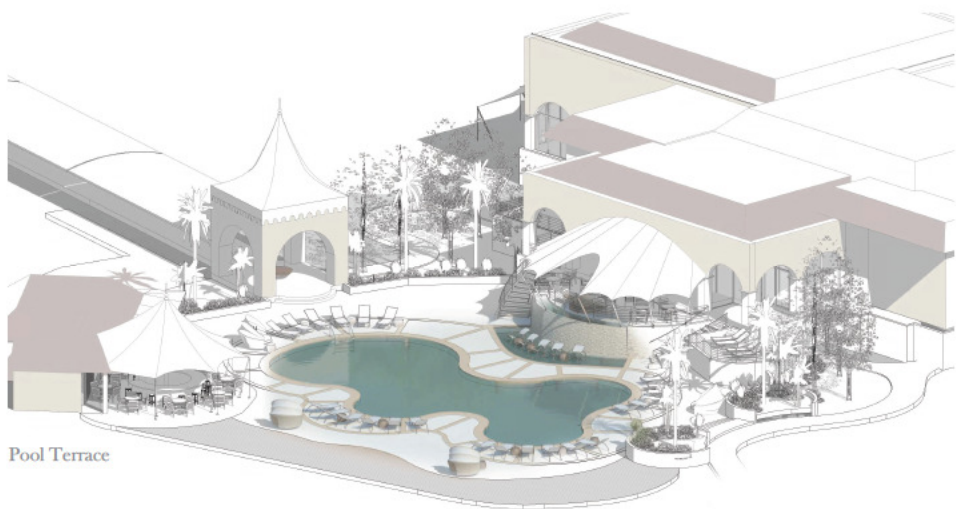

Pool Terrace



Pool Terrace



Sun Deck



Terrace Bar

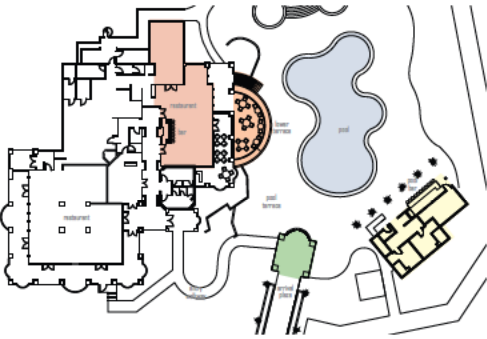

Existing Site Plan

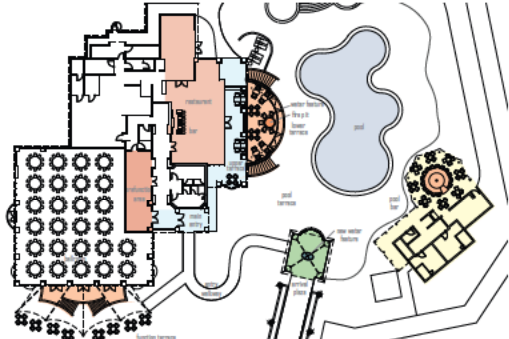

Proposed Site Plan



Porte Cochere



SPA WALKWAY EN-